

C Band 3300 Series PLL LNB



| Part Number | Input Frequency | Output Frequency | Output Conn |
|--|--|------------------------------------|------------------------|
| LNB515S-800P-WF60 LNB515S-800P-WN60 | 3.40 to 4.20 GHz 3.40 to 4.20 GHz | 950 to 1750 MHz 950 to 1750 MHz | F 75Ω (f) N 50Ω (f) |
| LNB515S-575P-WF60 LNB515S-575P-WN60 | 3.625 to 4.20 GHz 3.625 to 4.20 GHz | 950 to 1525 MHz 950 to 1525 MHz | F 75Ω (f) N 50Ω (f) |
| LNB515S-500P-WF60 LNB515S-500P-WN60 | 3.70 to 4.20 GHz 3.70 to 4.20 GHz | 950 to 1450 MHz 950 to 1450 MHz | F 75Ω (f) N 50Ω (f) |

*SMA output connectors also available

Specifications

www.orbitalresearch.net

| | | | |
|--------------------------------|---------------------------------|---------------------------|--|
| Noise Temp: | 25K (typ) @ +25°C | Input Conn: | WR-229G |
| LO Frequency Stability: | ≤ ±5 kHz over temperature range | Output Connector: | F-Type, 75Ω or N-Type, 50Ω |
| LO Phase Noise: | -80 dBc/Hz @ 1 kHz | MTBF: | >700,000 hours |
| LO Leakage: | -45 dBm max. | Input Voltage: | +12 to +24 VDC |
| Gain: | 60 dB typical | Current: | 250 mA max. |
| Gain Ripple: | 1 dB p-p max per 36 MHz segment | Size: | 144 x 68 x 39 mm 5.7 x 2.7 x 1.5 in |
| Image Rejection: | >45 dBc max. | Weight: | approx. 560g |
| 1dB Comp. point: | +10 dBm min. | Temp Range: | -40°C to +60°C |
| Input VSWR: | 2.2 : 1 | Relative Humidity: | Up to 100%, frost and condensation |
| Output VSWR: | 1.5 : 1 max @ 75Ω | | |

David Zuvic, 1-604-856-0305
dzuvic@orbitalresearch.net

Mechanical Diagram

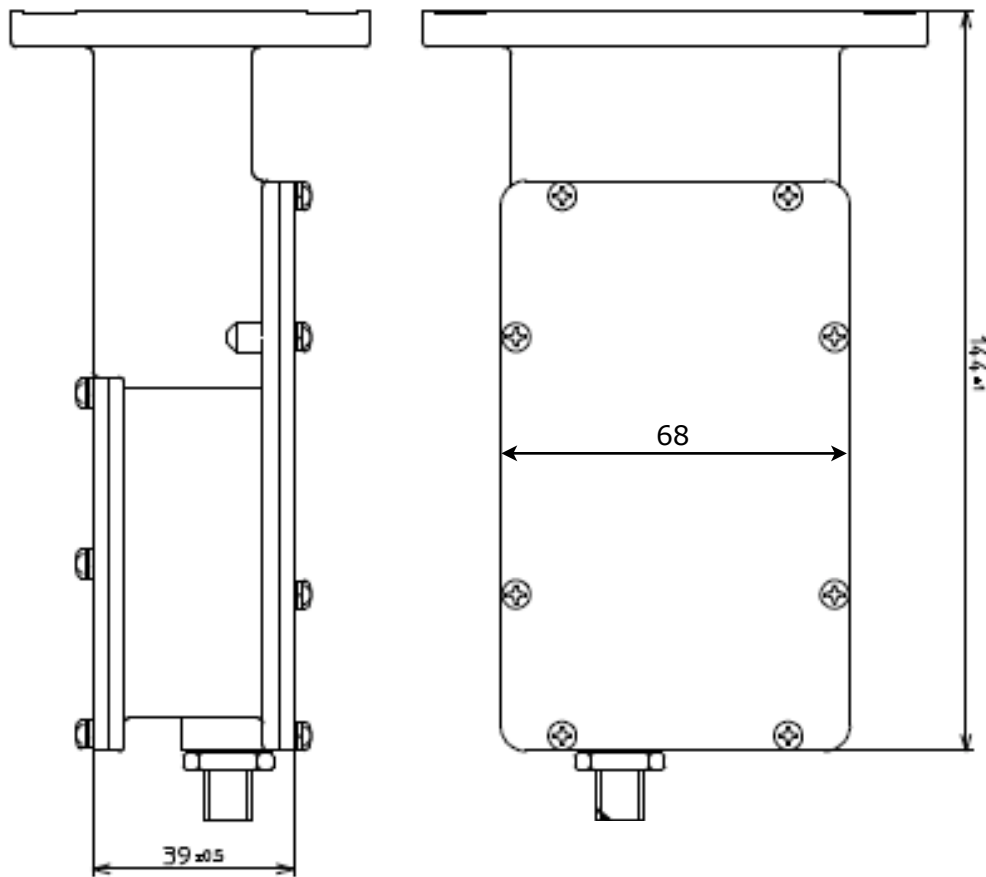
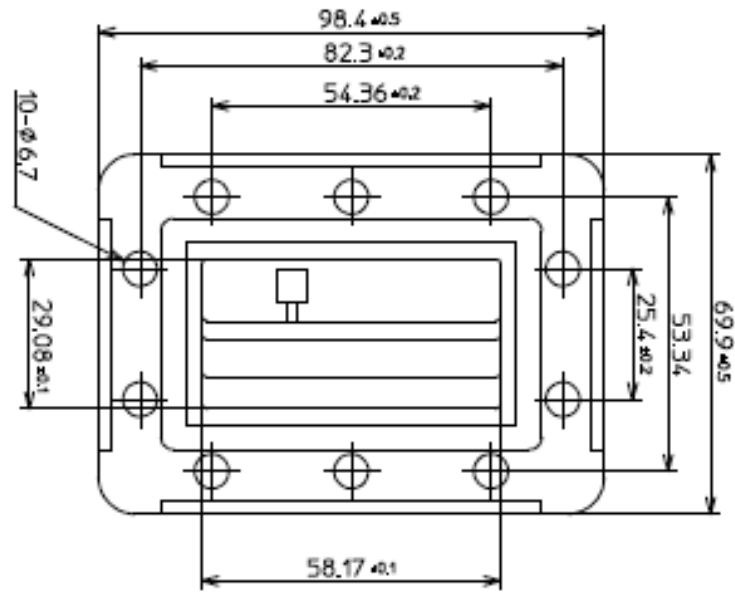

RoHS & REACH Compliant